

THIS PLAN IS PREPARED FOR SUBMISSION TO DEPARTMENT FOR PLANNING LANDS AND HERITAGE FOR THE PURPOSE OF SUBDIVISION ONLY. NOT TO BE USED FOR ANY OTHER PURPOSES WITHOUT PERMISSION.
 ALL DIMENSIONS AND AREAS SHOWN ARE APPROXIMATE AND SUBJECT TO VARIATION/SURVEY AND ANY OTHER EASEMENTS AND ENCUMBRANCES, WHICH MAY REASONABLY BE IMPOSED AS A RESULT OF THE SUBDIVISION.

THIS PLAN IS SUBJECT TO COUNCIL / W.A.P.C. APPROVAL
sp74009
113

TOTAL AREA
1308m²

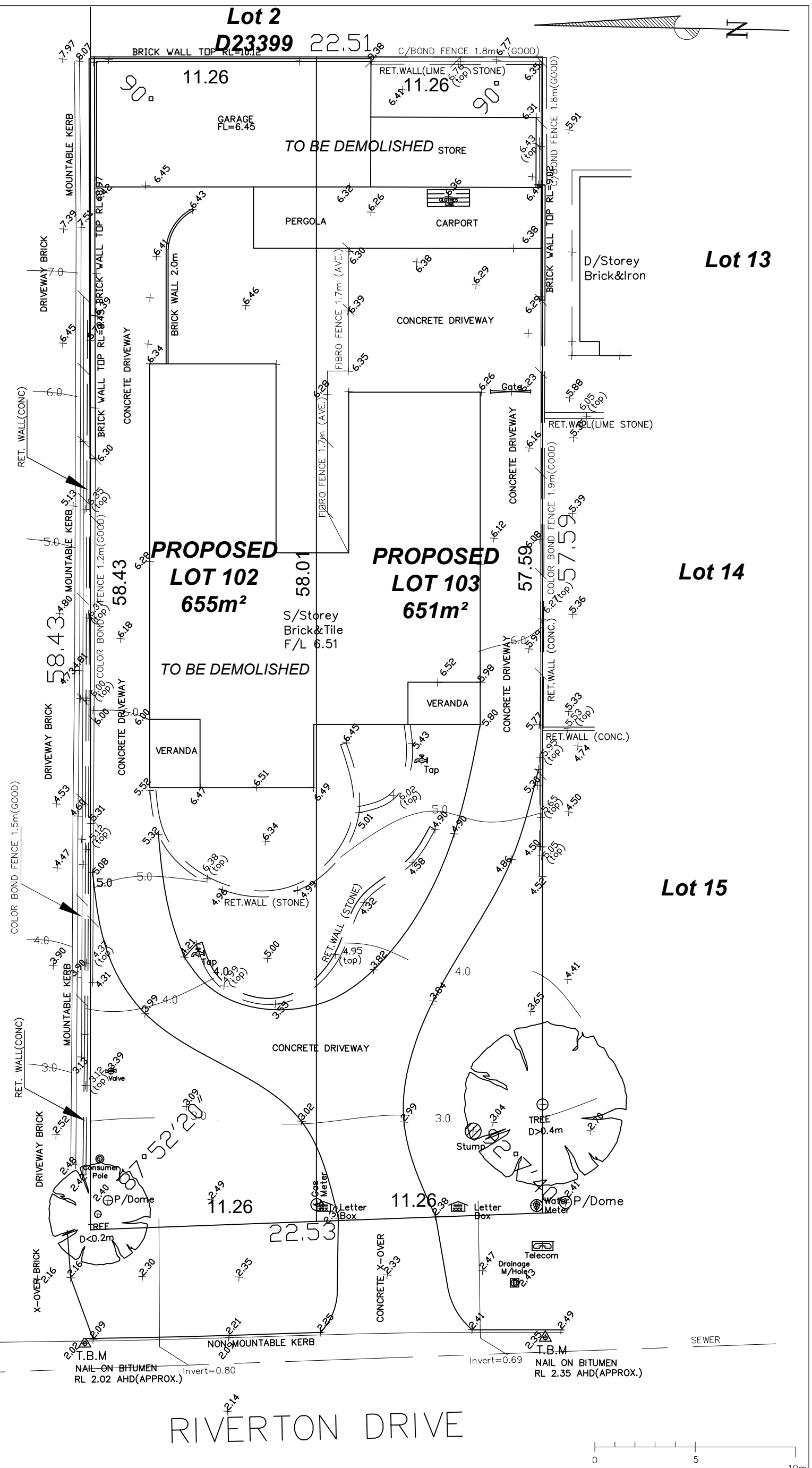

PROPOSED GREEN TITLE PLAN OF LOTS 1 AND 2 ON SP1225 119A,119B RIVERTON DR W, ROSSMOYNE		Site survey only location of boundary pegs or fences in relation to the boundary is not guaranteed
SCALE: 1:200	C/T: 2063/548; 1326/393 LOCAL AUTHORITY: CITY OF CANNING	
BANESH BOODHOO:0419914983		CHECKED BY: